



IN LIFE

e-Doorman user manual

The e-Doorman application allows you to monitor who enters and who leaves the apartment.

We launch the application by clicking the InLife Central icon.

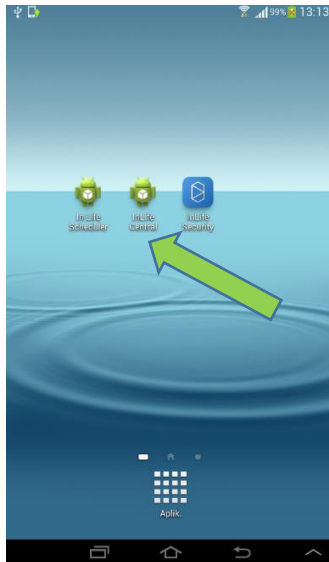

Horizon 2020

Doktor 24

DiU

Department of Intelligent Systems

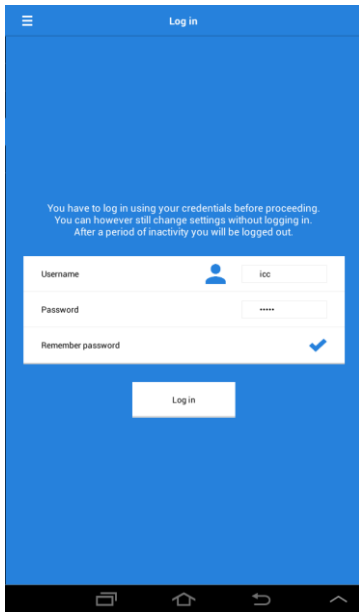

This opens the log in screen, where we enter our user name and password (you got these separately).

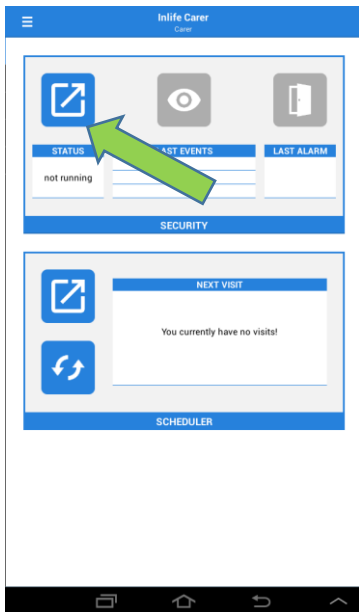

In the application, we choose the Security icon (top menu).

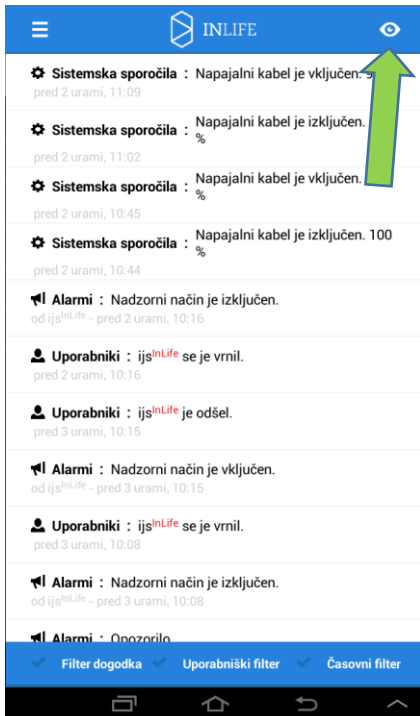

We get the list of notifications, such as registered arrivals and departures of users.

Before we leave the apartment, we click the »eye« icon in the top right corner.

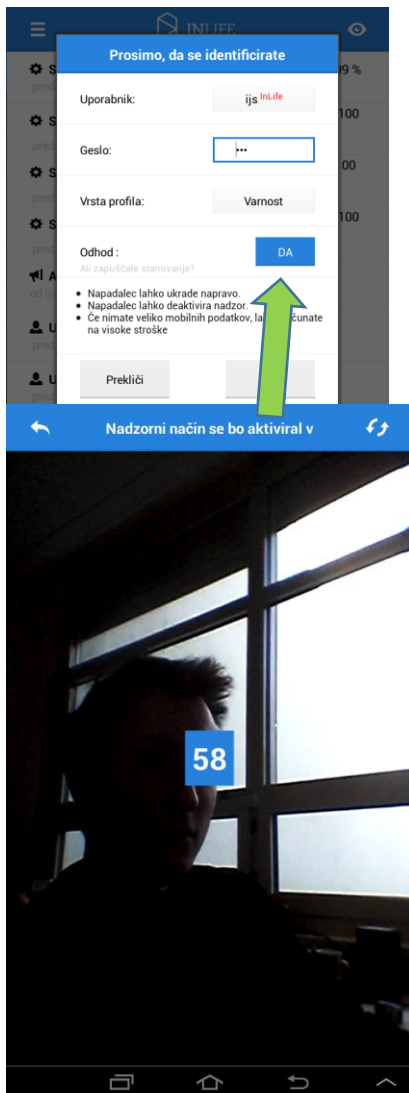

This opens the identification menu where we mark "yes". If there is only one user, this is the default choice. Otherwise, we can choose the user from the menu.

This launches the surveillance mode that starts in one minute (the blue square in the middle of the screen shows the countdown). This mode activates the camera which automatically detects the movement in the room and takes a photo of the person in the room (potential burglar).

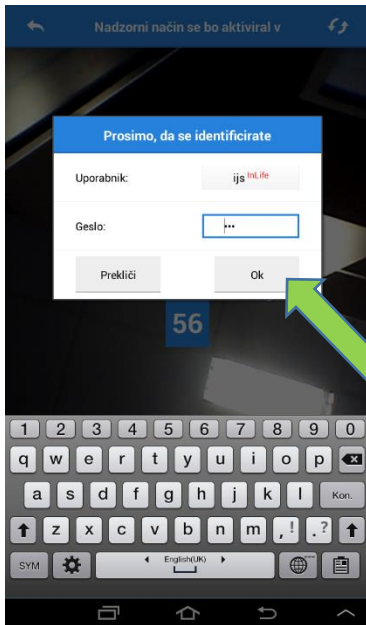

When we return home, we click the screen and mark that we arrived. This way we exit the surveillance mode.